

# DFC/SFC

## Female Connector

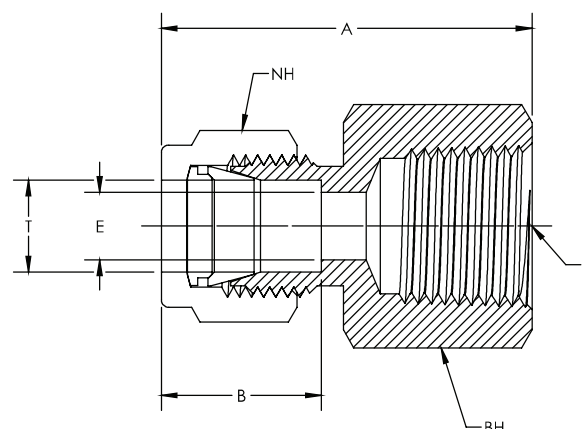
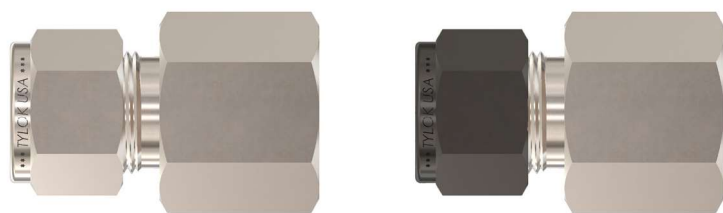

CBC PART NUMBER	INTERCHANGES WITH		CS PART NUMBER	INTERCHANGES WITH		T TUBE O.D.	P PIPE END NPT	A	B	E THRU HOLE	NH NUT HEX	BH BODY HEX
2-DFC-2	200-7-2	2FSC2N	2-SFC-2	2-2 GBZ	1/8	1/8	1.14	0.52	0.09	7/16	9/16	
2-DFC-4	200-7-4	2FSC4N	2-SFC-4	2-4 GBZ	1/8	1/4	1.33	0.52	0.09	7/16	3/4	
2-DFC-6	-	-	2-SFC-6	-	1/8	3/8	1.39	0.52	0.09	7/16	7/8	
3-DFC-2	300-7-2	3FSC2N	3-SFC-2	3-2 GBZ	3/16	1/8	1.16	0.54	0.13	1/2	9/16	
3-DFC-4	3FSC4N	-	3-SFC-4	3-4 GBZ	3/16	1/4	1.35	0.54	0.13	1/2	3/4	
4-DFC-2	400-7-2	4FSC2N	4-SFC-2	4-2 GBZ	1/4	1/8	1.23	0.61	0.19	9/16	9/16	
4-DFC-4	400-7-4	4FSC4N	4-SFC-4	4-4 GBZ	1/4	1/4	1.42	0.61	0.19	9/16	3/4	
4-DFC-6	400-7-6	4FSC6N	4-SFC-6	4-6 GBZ	1/4	3/8	1.48	0.61	0.19	9/16	7/8	
4-DFC-8	400-7-8	4FSC8N	4-SFC-8	4-8 GBZ	1/4	1/2	1.67	0.61	0.19	9/16	1 1/16	
5-DFC-2	500-7-2	5FSC2N	5-SFC-2	5-2 GBZ	5/16	1/8	1.27	0.65	0.25	5/8	9/16	
5-DFC-4	500-7-4	5FSC4N	5-SFC-4	5-4 GBZ	5/16	1/4	1.46	0.65	0.25	5/8	3/4	
5-DFC-6	5FSC6N	-	5-SFC-6	5-6 GBZ	5/16	3/8	1.52	0.65	0.25	5/8	7/8	
5-DFC-8	-	-	5-SFC-8	-	5/16	1/2	1.71	0.65	0.25	5/8	1 1/16	
6-DFC-2	600-7-2	6FSC2N	6-SFC-2	6-2 GBZ	3/8	1/8	1.29	0.67	0.28	11/16	5/8	
6-DFC-4	600-7-4	6FSC4N	6-SFC-4	6-4 GBZ	3/8	1/4	1.48	0.67	0.28	11/16	3/4	
6-DFC-6	600-7-6	6FSC6N	6-SFC-6	6-6 GBZ	3/8	3/8	1.54	0.67	0.28	11/16	7/8	
6-DFC-8	600-7-8	6FSC8N	6-SFC-8	6-8 GBZ	3/8	1/2	1.73	0.67	0.28	11/16	1 1/16	
6-DFC-12	600-7-12	6FSC12N	6-SFC-12	6-12 GBZ	3/8	3/4	1.89	0.67	0.28	11/16	1 5/16	
8-DFC-4	810-7-4	8FSC4N	8-SFC-4	8-4 GBZ	1/2	1/4	1.59	0.90	0.41	7/8	13/16	
8-DFC-6	810-7-6	8FSC6N	8-SFC-6	8-6 GBZ	1/2	3/8	1.65	0.90	0.41	7/8	7/8	
8-DFC-8	810-7-8	8FSC8N	8-SFC-8	8-8 GBZ	1/2	1/2	1.84	0.90	0.41	7/8	1 1/16	
8-DFC-12	810-7-12	8FSC12N	8-SFC-12	8-12 GBZ	1/2	3/4	1.90	0.90	0.41	7/8	1 5/16	
8-DFC-16	810-7-16	-	8-SFC-16	-	1/2	1	2.27	0.90	0.41	7/8	1 5/8	
10-DFC-4	-	-	10-SFC-4	-	5/8	1/4	1.80	0.96	0.44	1	15/16	
10-DFC-6	1010-7-6	10FSC6N	10-SFC-6	10-6 GBZ	5/8	3/8	1.65	0.96	0.50	1	15/16	
10-DFC-8	1010-7-8	10FSC8N	10-SFC-8	10-8 GBZ	5/8	1/2	1.83	0.96	0.50	1	1 1/16	
10-DFC-12	1010-7-12	10FSC12N	10-SFC-12	10-12 GBZ	5/8	3/4	1.90	0.96	0.50	1	1 5/16	
12-DFC-6	1210-7-6	-	12-SFC-6	-	3/4	3/8	1.67	0.96	0.56	1 1/8	1 1/16	
12-DFC-8	1210-7-8	12FSC8N	12-SFC-8	12-8 GBZ	3/4	1/2	1.84	0.96	0.63	1 1/8	1 1/16	
12-DFC-12	1210-7-12	12FSC12N	12-SFC-12	12-12 GBZ	3/4	3/4	1.90	0.96	0.63	1 1/8	1 5/16	
12-DFC-16	1210-7-16	-	12-SFC-16	-	3/4	1	2.28	0.96	0.63	1 1/8	1 5/8	
14-DFC-8	-	-	14-SFC-8	-	7/8	1/2	1.83	1.02	0.70	1 1/4	1 3/16	
14-DFC-12	1410-7-12	14FSC12N	14-SFC-12	14-12 GBZ	7/8	3/4	1.96	1.02	0.72	1 1/4	1 3/8	
16-DFC-6	-	-	16-SFC-6	-	1	3/8	2.15	1.24	0.56	1 1/2	1 3/8	
16-DFC-8	1610-7-8	-	16-SFC-8	-	1	1/2	2.15	1.24	0.70	1 1/2	1 3/8	
16-DFC-12	1610-7-12	16FSC12N	16-SFC-12	16-12 GBZ	1	3/4	2.12	1.24	0.88	1 1/2	1 3/8	
16-DFC-16	1610-7-16	16FSC16N	16-SFC-16	16-16 GBZ	1	1	2.46	1.24	0.88	1 1/2	1 5/8	

NOTE: Dimensions subject to change, to be used for reference only.